

How to find and integrate Google ads conversion id and conversion label?

Step 1:

Log in to your Google ads accounts and Navigate to Tools and Settings > Conversions [Under Measurement tab]

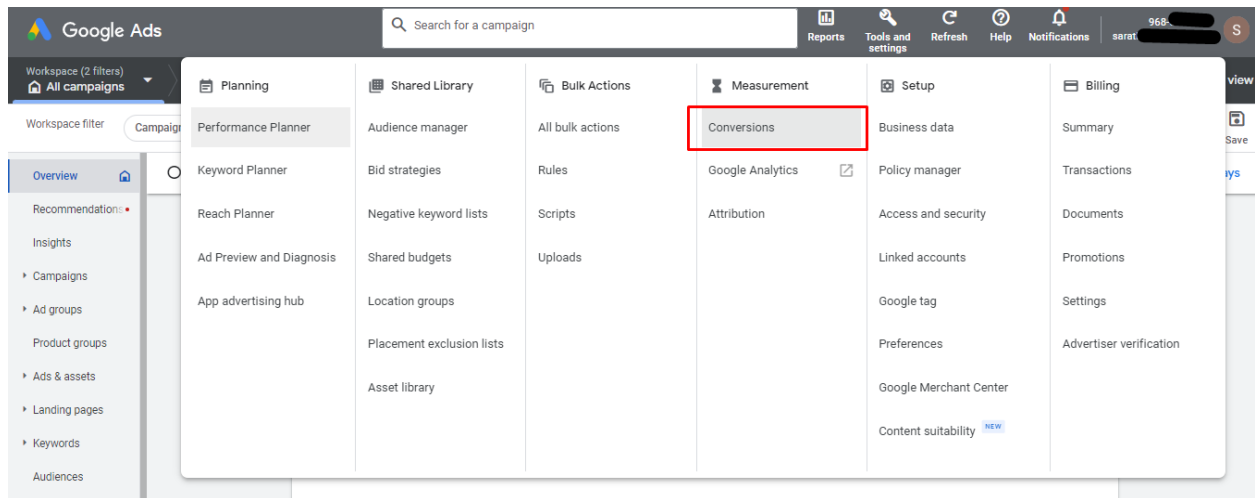

[Screenshot 1.1]

Step 2:

Click on the Conversion action of the specific id that you wanted to integrate (Refer to Screenshot 2.1)

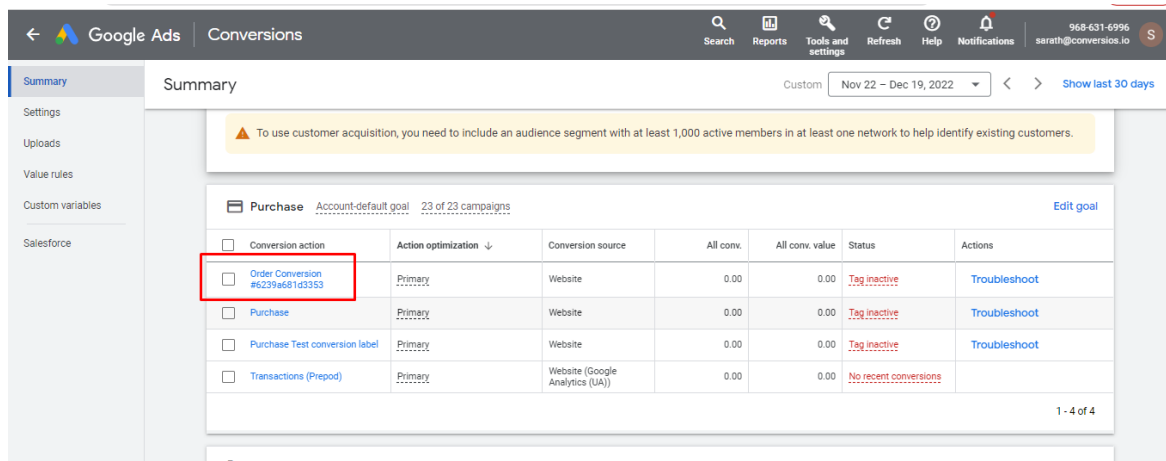

[Screenshot 2.1]

Step 3:

You will be redirected to the details page of that specific conversion action and select the Tag Setup (Refer to screenshot 3.1)

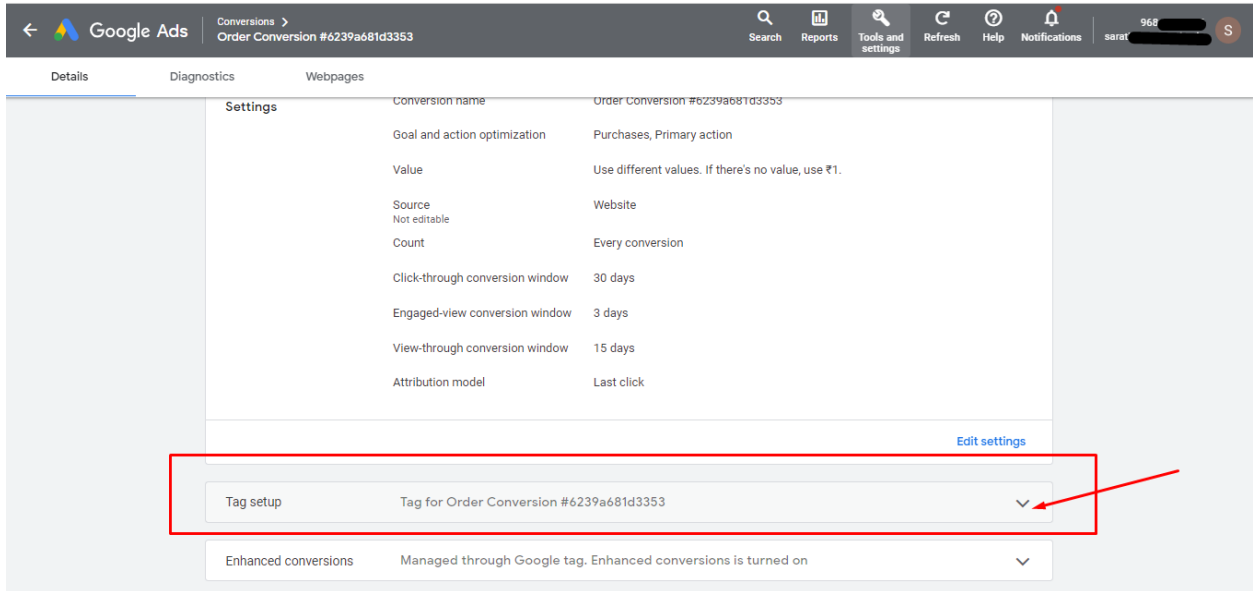

[Screenshot 3.1]

Step 4:

Click on the Install Tag Yourself option (Refer to screenshot 4.1)

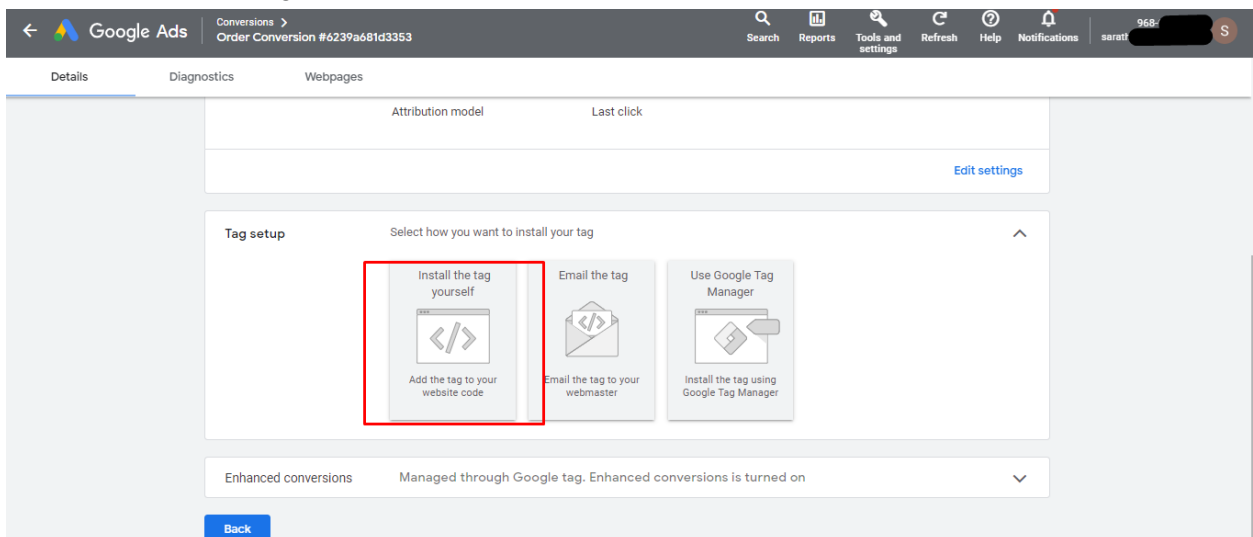

[Screenshot 4.1]

You will see the Google ads Conversion id as under the Google tag options

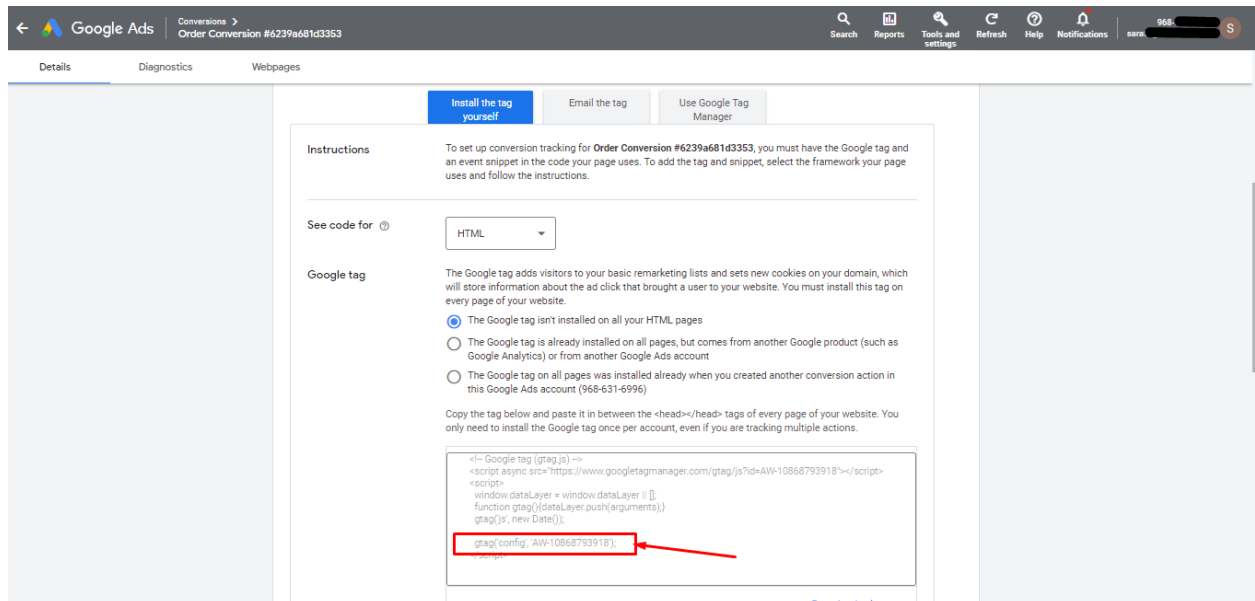

Step 5:

Scroll a bit down you will see the events Snippet where you can find the Conversion label for that specific conversion id (Refer to screenshot 5.1)

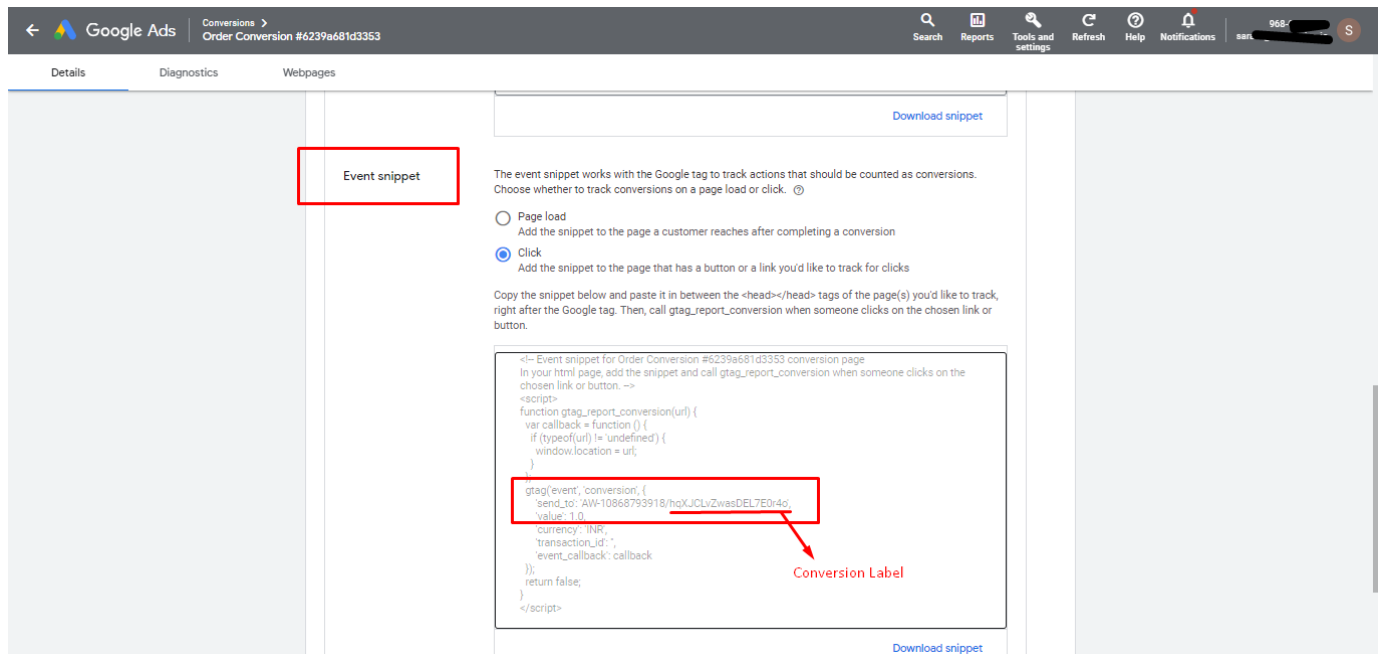

[Screenshot 5.1]



Need Help? Please reach out to us at info@conversios.io for any technical help or support. OR you can [set up a call with our expert for a quick product walkthrough](#).
